

A17(HP)-NC298 Parts Diagram

ENGINE SYSTEM

NO	PART NUMBER	NAME	DESCRIPTION	QTY
1	06.04.0014	NC298 engine/Zongshen body + magic square cylinder/assembly (EGL standard)/H7 special	Magic Square 298 sets of cylinders, Zongshen body, cylinder head, box shot blasting + left and right side covers black/electric foot start, with high speed limit CDI (including small flying cover, starting rod, sealing gasket, intake pipe FA7D, clamp, igniter, relay, rectifier)	1
2	06.05.0004	Intake pipe		1
3	06.27.0001	Carburetor PWK34/NIBBI/with manifold glue, stainless steel hoop	Main hole 132 / auxiliary hole 32 / oil needle PWK24J-01-03-01 (A2) / idling adjustment screw / manual thickening / with K7-H7-A7-NC250-300/CBS300/NC biconvex	1
4	06.41.0001	Clutch arm bracket/CNC	orange	1
5	03.02.0033	Engine hanger / left / H7-01		1
6	03.02.0034	Engine hanger / right / H7-01	Laser cutting stamping silver spray molding	1
7	06.27.0126	Main and auxiliary hole kit/PWK34/NIBBI/packing		1
8	06.05.0001	Small fly cover for engines	Main measuring holes 128/130/132/135/138 Secondary measuring holes 30/32/35/38/40	1
9	03.01.0045	Gear lever - 2A/A7-01	Aluminum alloy anodized natural color	1
10	06.05.0002	Start lever		1
11	05.02.03.0104	All-metal hex flange face lock nut	M10/white zinc plated	2
12	05.01.02.10130D	Hexagonal flange face bolts	M10*130/white zinc plated	2
13	05.02.03.0103	All-metal hex flange face lock nut	M8	2
14	05.01.02.08125D	Hexagonal flange face bolts	M8*125	2
15	03.02.0032	Engine front hanger / H7-01	Laser cut black spray	1
16	03.02.0086	Engine front hanger spacer	22*10*10	2

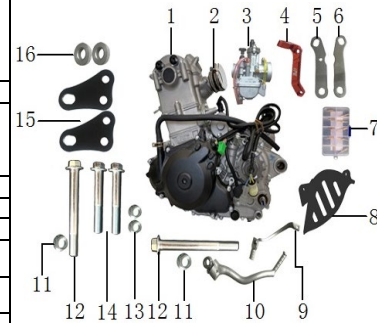

EXHAUST SYSTEM

NO	PART NUMBER	NAME	DESCRIPTION	QTY
1	03.02.0067	Front exhaust pipe/H7-01/double row/250cc	Stainless steel/single layer 1.5mm with pressure back pack	1
	03.02.0068	Exhaust pipe midsection/H7-01/double row/250cc	Stainless steel/tee	1
	03.02.0132	Rear exhaust pipe/left/H7-01/double row/250CC	Stainless steel barrel / tail cover aluminum / muffler with elbow	1
	03.02.0133	Rear exhaust pipe/right/H7-01/double row/250C		1
2	05.02.03.0103	All-metal hex flange face lock nut	M8	3
3	03.01.0236	Exhaust pipe sealing gasket C	Exhaust pipe accessories	1
4	03.01.0100	Exhaust pipe spring/A7-02/long	stainless steel	2
5	05.01.02.08020D	Hexagonal flange face bolts	M8*20	1
6	05.01.02.08025D	Hexagonal flange face bolts	M8*25	2
7	05.05.01.0104	Flat washers	ø8*ø24*2 / white zinc	2

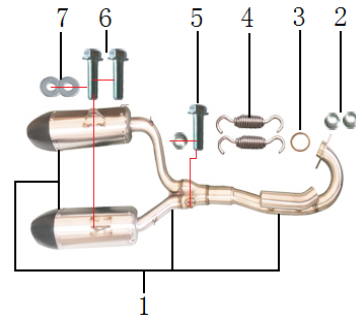

TRIPLE CLAMP SYSTEM

NO	PART NUMBER	NAME	DESCRIPTION	QTY
1	05.01.04.08025B	Allen cylindrical head screw	M8*25/stainless steel	4
2	03.02.0155	Upper briquette/H7-01	FORGED ALUMINUM ALLOY	2
3	03.02.0157	Press/H7-01	ANODE/REDUCER MOUNTING HOLE 28.5MM/BLACK	1
4	03.02.0147	Uplink board/H7-01	Forged aluminum alloy anode/black/54*190	1
5	05.02.03.0104	All-metal hex flange face lock nut	M10/white zinc plated	2
6	03.02.0097	Steering post lock nut/H7-01	ALUMINUM ALLOY ANODE NATURAL COLOR 30MM	1
7	03.02.0038	Steering column dust cover/H7-01	65*30*3	2
8	05.01.02.08040D	Hexagonal flange face bolts	M8*40/white zinc plating	8
9	03.02.0292	Bottom plate/H7-01/black	Forged aluminum alloy anode black 60*190MM	1
10	03.02.0158	Directional Limit Block/H7-01	Aluminum alloy anode/silver	2
11	05.01.02.06025D	Hexagonal flange face bolts	M6*25/white zinc plated	4
12	03.02.0036	Direction column/H7-01	Aluminum alloy 7075	1
13	05.04.01.0003	Tapered roller bearings (32006X)	ø 30* ø 55*17	2
14	03.02.0080	Hand tube cushioning conical sleeve/H7-01	Frame strap	4
15	03.02.0249	AB bolts/lower briquettes	ø12*75 (one side M10 thread. One side M12 thread)	2
16	03.02.0098	Upper coupling lock nut/H7-01		1

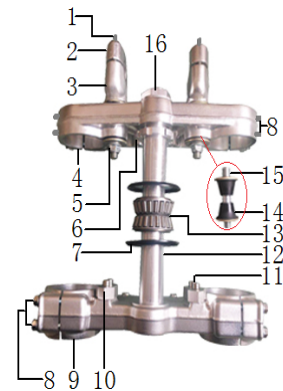

FRAME SYSTEM

NO	PART NUMBER	NAME	DESCRIPTION	QTY
1	03.02.0116	Main frame/H7	WATER COOLED 250CC	1
2	03.02.0101	Tank mid-tank cushion / H7-01	Black rubber	2
3	03.02.0102	Rear bumper pad of fuel tank/H7-01		1
4	05.01.02.08025D	Hexagonal flange face bolts	M8*25/white zinc plated	2
5	03.02.0117	Subframe/H7	Water-cooled/aluminum alloy anode sandblasted silver	1
6	03.01.0019	Guide sprocket/top/A7-01	Black boreø8mm, with bearings	1
7	05.01.02.08040D	Hexagonal flange face bolts	M8*40/white zinc plating	1
8	05.01.02.10025D	Hexagonal flange face bolts	M8*25/white zinc plated	2
9	05.01.02.06012D		M6*12/white zinc plated	4

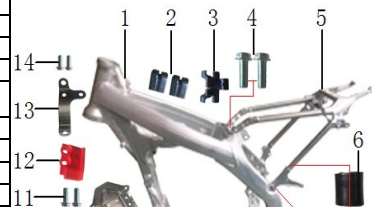

10	03.02.0035	Engine guard/H7-01	Aluminum alloy stamping	1	
11	05.01.02.06016D	Hexagonal flange face bolts	M6*16/white zinc plated	2	
12	03.02.0062	Chain grinding block/H7	Red polyurethane rubber (black manufacturers do not do)	1	
13	03.02.0078	Line card bracket/H7-01	Stamping of stainless steel	1	
14	05.01.15.05008D	Cross-grooved small pan head screws	M5*8 white zinc plated	2	

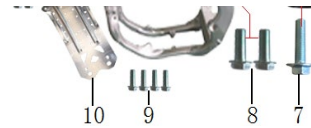

FOOTPEGS/BRAKE PEDAL/SIDE STAND					
NO	PART NUMBER	NAME	DESCRIPTION	QTY	
1	03.02.0042	Foot peg / left / H7-01	Stainless steel parts	1	
	03.02.0043	Pedal peg / right / H7-01		1	
2	03.02.0046	Foot peg bracket/left/H7-01		1	
	03.02.0047	Foot peg bracket / right / H7-01		1	
3	05.01.02.08025D	Hexagonal flange face bolts	M8*25/white zinc plated	2	
4	05.01.02.12025D		M12*25*1.75	2	
5	03.06.0039	Foot peg return spring/left/K7-01		1	
6	03.06.0040	Foot peg return spring/right/K7-01		1	
7	03.01.0076	Foot peg mounting pin/A7-01	Stainless steel 10*50MM	2	
8	05.06.01.0101	Foot peg mounting pin/A7-01	35MM/Original Foot Mounting Pin / A7-01	2	
9	05.01.12.06016B	Allen semi-round head bolts	M6*16/stainless steel	2	
10	03.04.0407	Rear brake lever aluminum head/K3	Silver aluminum head	1	
11	03.02.0019	Side stand/H7-01 long	Silver L: 365mm/18-21/Shrink/M10x1.25	1	
12	03.01.0032	Side stand spring/A7-01		1	
13	03.01.0031	Side stand spring hanging plate/A7, H7		1	
14	05.80.08.10030D	Hex step bolts	M10*30	1	
15	05.02.01.0103	Hex nut	M10	2	
16	03.02.0075	Rear brake lever spacer sleeve/H7-01	Black/420*412*3.8	1	
17	05.80.04.10035C	Allen large flat head screw (green ink plated)	10*35/ with steps	1	
18	03.02.0017	Rear brake return spring/H7-01		1	
19	03.02.0149	Rear brake lever/H7-01	Forged aluminum alloy anode/silver	1	

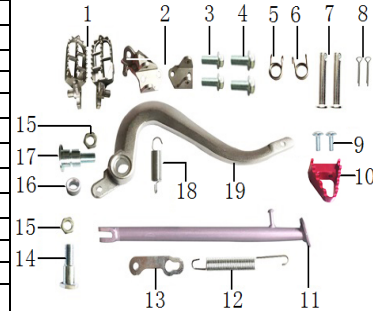

LINKAGE SYSTEM					
NO	PART NUMBER	NAME	DESCRIPTION	QTY	
1	05.04.04.0006	Needle roller bearings (HK2012)	420*426*12	2	
2	03.02.0114	Rocker bearing bushings	12*20*82	1	
3	03.02.0179	Rocker seal	φ20*φ32*5	6	
4	05.04.04.0005	Needle roller bearings (HK2020)	420*426*20	4	
5	03.02.0115	Rocker bearing bushings	12*20*55	2	
6	05.01.02.12105D	Hexagonal flange face bolts	M12*105 white zinc plated	1	
7	05.02.03.0105	All-metal hex flange face lock nut	M12 white zinc plated	3	
8	05.01.02.12095D	Hexagonal flange face bolts	M12*95 white zinc plated	1	
9	03.01.0104	Rocker seal	18*26*3	2	
10	03.01.0174	Rocker bearing bushings	10*18*20	1	
11	05.04.04.0004	Needle roller bearing(NKF182614)	18*26*14/full needle	1	
12	03.02.0054	Guide sprocket/down/H7-01	Black boreφ10mm with bearings	1	
13	03.02.0079	Lower sprocket bracket/H7-01		1	
14	05.01.02.12135D	Hexagonal flange face bolts	M12*135 white zinc plated	1	
15	03.02.0104	Rocker fork/H7-01	Aluminum alloy anode sandblasted silver	1	
16	03.02.0103	Triangular Rocker/H7-01		1	

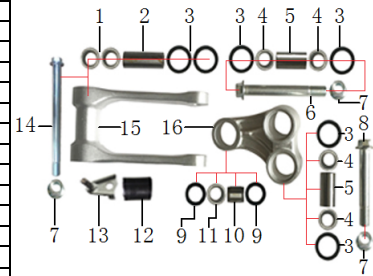

SWINGARM SYSTEM					
NO	PART NUMBER	NAME	DESCRIPTION	QTY	
1	03.02.0039	Rear swingarm/H7	250CC aluminum alloy surface polished	1	
2	03.02.0160	Swingarm guide/H7-01	Black/polyurethane rubber/guide chain	1	
3	05.80.04.06010D	Allen large flat head screw (white zinc plated)	M6*10/with steps	1	
4	03.02.0072	Swingarm fixing cover/H7-01	Black electrophoresis	2	
5	03.01.0142	Rear brake hose clamp/A7-01	Black PP plastic	2	
6	03.02.0071	Swingarm end face gasket/H7	Laser cutting white zinc plating	1	
7	03.02.0136	Chain regulator/right/H7-01		1	
8	03.02.0135	Chain regulator/left/H7-01		1	
9	05.01.01.08050C	Hex head bolts	M8*50/Dark green plating	2	
10	05.02.01.0002	Hex nut	M8/Inky green plated	2	
11	03.02.0041	Swingarm rocker spacer sleeve/H7-01	T-type partition sleeve φ24*φ12*5 φ16*φ12*12	2	
12	05.01.07.05008D	Cross-groove countersunk screws	M5*8 white zinc plated	6	
13	05.01.02.06060D	Hexagonal flange face bolts	M6*60/white zinc plated	2	
14	05.01.02.06016D	Hexagonal flange face bolts	M6*16/white zinc plated	1	
15	03.02.0161	Chain guide/H7-01	black	1	
16	03.01.0188	Swingarm spacer sleeve	18*28*6	2	
17	03.02.0141	Swingarm seal	28*37*4	2	
18	05.04.06.0002	Thrust bearing/H7-01 (gasket required)	36*22*6	2	
19	03.02.0142	Swingarm bushings	22*17*55	1	
20	03.02.0143	Swingarm bushings	22*17*49	1	
21	05.04.04.0008	Needle roller bearings	422*430*20 (K8 flat fork)	2	
22	03.02.0140	Swingarm seal	22*29*5	2	
23	05.02.03.0107	All-metal hex flange face lock nut	M16 white zinc plated	1	
24	05.80.02.17248D	Swingarm shaft/H7/white zinc plated/non-standard	17*248	1	



SUSPENSION SYSTEM				
NO	PART NUMBER	NAME	DESCRIPTION	QTY
1	05.80.04.06010D	Allen large flat head screws	M6*10/with steps	6
2	03.01.0068	Front fork shield / left / with 940 front reduction	KKE front fork absorbing equipment	1
3	03.01.0069	Front fork shield / right / with 940 front reduction		1
4	05.01.13.10043D	T-slot bolts	M10*43	1
5	05.02.03.0104	All-metal hex flange face lock nut	M10	2
6	03.02.0088	REAR SHOCK / 482MM/KKE/350 LBS	A46AOL/Airbag Dual Adjustable/Black Spring 350 lbs/L=482MM	1
7	05.80.14.10065D	Rear shock absorption on bolts/non-standard	Missing edge bolts/M10*65/white zinc plating	1
8	06.29.0121	Front fork absorbing dust cover/48*58*(62)*13.5/KKE	Equipped with 940 front shock absorption/48*58*(62)*13.5/D41A0	2
9	06.29.0120	Front fork absorber oil seal/48*57.8*9.5*12/KKE	With 940 front shock absorption/48*57.8*9.5*12/KKE/D41A0	2
10	03.01.0389	FRONT FORK ABSORPTION/RIGHT/940MM/KKE	SINGLE CAVITY/D48A0/BLACK/54-60, L=940MM, 448MM, 103MM, SINGLE CAVITY DOUBLE ADJUSTABLE	1
11	03.01.0388	FRONT FORK ABSORPTION/LEFT/940MM/KKE	SINGLE CAVITY/D48A0/BLACK/54-60, L=940MM, 448MM, 103MM, SINGLE CAVITY DOUBLE ADJUSTABLE	1

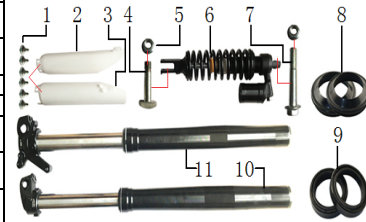

CONTROL SYSTEM				
NO	PART NUMBER	NAME	DESCRIPTION	QTY
1	03.01.0379	Front brake master assembly/A7/Nissin/Sport/North Sea	UPPER PUMP BODY SMALL OIL CUP / ALUMINUM ALLOY SILVER WHITE DOUBLE PISTON / OIL PIPE 1280MM	1
1-1	06.08.0502	Front brake mount/A7-01	M8*103/with Nissin brake/with 4270mm/with AJ295 bracket	1
1-2		Front brake lower caliper/AJ		1
1-3		Front disc brake rotor/AJ		1
1-4		Front brake tubing/AJ		1
2	06.08.0584	Brake lever/IGP/with Nissin Racing small oil cup	Black/red/three-way foldable/IGP/with Nissin Competitive small oil cup	1
3	03.01.0011	Rear brake master assembly/A7/Nissin/Regular	ALUMINUM ALLOY SILVER WHITE TUBING 600MM	1
3-1		Rear brake hose/AJ		1
3-2		Rear brake lower caliper/AJ		1
3-3		Rear brake mount/AJ		1
3-4		Rear disc brake pad/AJ		2
3-5		Rear brake master/AJ		1
4	03.01.0254	Handlebar grip/right	φ24/length 115mm/black	1
5	06.44.0004	Handlebar tube 7075	Aluminum alloy / black / with scale / diameter 28.5-22	1
6	03.06.0091	THROTTLE seat assembly/K7/ with LIKEE marking	Contains core/aluminum die-casting/black/large torsion oil	1
7	06.31.0002	Start switch/ignition switch	TWO-HOLE WATERPROOF INSERT CABLE LENGTH 720MM	1
8	03.06.0019	Rear brake disc guard/K7-01	White plastic	1
9	03.06.0018	Rear brake guard/K7-01		1
10	03.01.0132	Clutch handle assembly/IGP	Black/red/three directions foldable/IGP	1
11	06.31.0003	Flame-out switch	TWO-HOLE WATERPROOF INSERT CABLE LENGTH 720MM	1
12	03.01.0253	Handlebar grip/left	φ21/length 115mm/black	1
13	03.01.0182	Clutch cable/YKZM-CLU	Core 1120, leather length 1040, stroke 80	1
14	03.07.0061	Throttle cable/ZMX7-250	METAL TUBE, LEATHER LENGTH 970MM, TOTAL LENGTH 1115MM, STROKE 137MM	1

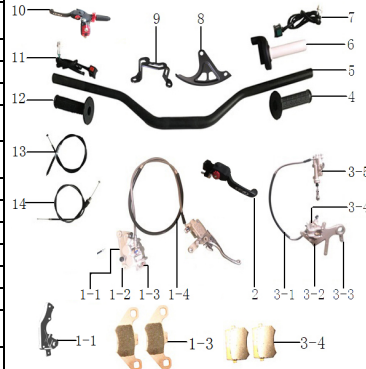

FRONT WHEEL SYSTEM				
NO	PART NUMBER	NAME	DESCRIPTION	QTY
1	03.02.0278	Front rim assembly/1.6*21	CR2016 black cast drum core/1.60*21/7116 black outer ring double nozzle/9K stainless steel spokes/copper riser/human-oriented bearing/no marking	1
1-1		Aluminum rim only	Black outer ring	1
1-2		Stainless steel copper riser/front/9K		36
1-3		Spoke		36
1-4		Hub core	CR2016 black cast drum core	1
2	06.42.0379	Front tire 80/100-21/Far Star/Deep teeth	80/100-21	1
3	06.42.0380	Front wheel tube/80*100-21/Vista		1
4	06.42.0319	Tube lock cushion		1
5	06.42.0315	Front tube lock	1.6# green polyurethane	1
6	05.05.01.0108	Flat washers	φ8*φ16*1.5 stainless steel	1
7	05.02.07.0001	Hex nut	M8	1
8	06.19.0027	Front wheel drum core spacer sleeve	φ 20X φ 25X71	1
9	05.02.03.0107	All-metal hex flange face lock nut	M16	1
10	05.80.11.001	Front axle/A7	20*233/non-standard (entry)	1
11	06.42.0110	Front wheel seal	φ 26* φ 37*7	2
12	05.04.03.0022	Deep groove ball bearings(6904)		2
13	05.01.01.06020B	Hex head bolts	M6*20/stainless steel	6
14	05.02.03.0110	All-metal hex flange face lock nut	M6	6
15	06.08.0307	FRONT DISC BRAKE DISC/270MM/AJ	AJ/KTM-02/Flower tray 6 holes/270mm/inner hole 102mm/mounting hole pitch 117mm/with magnetic steel hole	1
16	06.42.0020	Front wheel spacer sleeve No. 12	Aluminum alloy anode black φ20*φ27*25.5	1



REAR WHEEL SYSTEM					
NO	PART NUMBER	NAME	DESCRIPTION	QTY	
1	03.02.0279	Rear rim assembly/2.15*18	CR2016 black cast drum core/2.15*18/7116 black outer ring double nozzle/8K stainless steel spokes/copper riser/human-oriented bearing/no marking	1	
1-1		Aluminum rim only		1	
1-2		Stainless steel copper riser/rear/8K		32	
1-3		Spoke		16	
1-4		Spoke		16	
1-5		Hub core	CR2016 black cast drum core	1	
2	06.42.0385	Rear tire 110/100-18/Vista/Deep Teeth	110/100-18/Far Star	1	
3	06.42.0384	Inner tube at the rear		1	
4	06.35.0038	Chain 520H-112L	Ultrasink KMC520H-112L/gray	1	
5	05.05.01.0108	Flat washers	Φ8*Φ16*1.5 stainless steel	1	
6	05.02.07.0001	Hex nut	M8	1	
7	06.19.0028	Rear wheel drum core spacer sleeve	Φ 25X Φ 30X100	1	
8	06.42.0316	Rear tube lock/green	2.15# Green polyurethane	1	
9	06.42.0105	Seal for the rear wheel	32*47*7	2	
10	05.04.03.0024	Deep groove ball bearings(6905)	NSK	3	
11	03.07.0116	Rear sprocket 520-47T	Steel / white zinc plated / Honda model / inner hole 125mm mounting hole 48*153mm	1	
12	05.02.03.0110	All-metal hex flange face lock nut	M8	10	
13	05.01.05.08033B	Allen countersunk stainless steel	M8*33	6	
14	06.08.0308	REAR DISC BRAKE DISC/240MM/4-HOLE/AJ	AJ/KTM-01/flower tray 4 holes/240mm/inner hole 122mm/mounting hole distance 140mm	1	
15	05.01.01.06020B	Hex head bolts	M6*20/stainless steel	4	
16	05.02.03.0111	All-metal hex flange face lock nut	M22/white zinc plated	1	
17	05.80.12.002	Rear axle/H7/non-standard (in-warehouse)	25*267MM hollow/with steps (entering the warehouse)	1	
18	06.42.0005	Rear wheel spacer sleeve No. 4 left	ALUMINUM ALLOY ANODE BLACK 25*29MM	1	
19	06.42.0006	Rear wheel spacer sleeve No. 4 Right	ALUMINUM ALLOY ANODE BLACK 25*23.5MM	1	

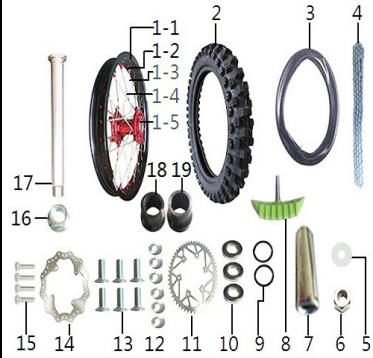

AIR FILTER SYSTEM					
NO	PART NUMBER	NAME	DESCRIPTION	QTY	
1	03.02.0055	Air filter intake hose/H7	Polyurethane rubber	1	
2	03.02.0146	Air filter hose waterproof sleeve/H7	White rubber tube	1	
3	03.02.0053	Air filter element/H7-01 (with sponge and mesh plate)	Air filter element K19	1	
4	03.02.0077	Air filter fixing bracket/H7-01	Iron stamping Silver spraying	1	
5	03.02.0056	Air filter pre-/H7	Black plastic	1	
6	03.02.0057	Air filter/H7		1	
7	03.01.0219	Air filter clamps	American stainless steel 46*70/40*65	1	
8	03.02.0144	Air filter clamps	Stainless steel 175*197*9	1	
9	05.80.01.06035B	Butterfly bolt (stainless steel)	M6*35	1	



ELECTRICAL PARTS					
NO	PART NUMBER	NAME	DESCRIPTION	QTY	
1	06.05.0007	Igniter		1	
2	06.14.0006	High voltage package/GY6	With high voltage line High pressure cap head is NC	1	
3	06.13.0006	Key,lock harness	Water-cooled / 2nd gear 3rd wire with headlight / 3.8 / cable length 220mm	1	
4	06.05.0008	Relay		1	
5	06.05.0009	Rectifier		1	
6	03.02.0145	Battery compartment spring/H7L	Stainless steel 2.2	1	
7	03.02.0030	Relay bracket/H7-01		1	
8	03.02.0260	High-pressure package bracket / H7/450 exclusive	Silver/sprayed	1	
9	03.02.0126	Rectifier bracket/H7-01		1	
10	03.02.0031	Ignition bracket/H7-01		1	
11	03.02.0027	Battery case/H7	Black/ filter cap	1	
12	06.12.0206	Lithium battery/12V7A/elite	EL2A-L-3200NP	1	
13	03.01.0043	Battery strap/A7-01		1	
14	03.02.0328	Main wire harness/Water Cooled/H7	Off-road model/lock/headlight/battery/meter/fan (original 03.02.0083 is added to the instrument)	1	
15	03.02.0106	Speed sensing harness/H7-01/	M10x1.25/waterproof insert	1	
16	03.02.0197	Speed Sensing Magnet/H7-01/	Circlips	1	
17	03.02.0026	Count sensor holder/H7-01	T2/laser cutting with Φ10.2 mounting holes	1	
18	03.02.0029	Instrument bracket/H7	Domestic	1	
19	03.02.0105	Instrumentation/LCD/H7-01	KR/200/3 magnets/21 inches	1	
20	03.07.0035	T3 headlight bushing/T8 front left and right decorative plate bushing/X7-01		2	



BODY PARTS					
NO	PART NUMBER	NAME	DESCRIPTION	QTY	
1	03.02.0287	Front side panel/left/H7	Red PP plastic parts	1	
	03.02.0288	Front side panel/right/H7		1	
2	03.02.0060	Midside panel/left/H7	red	1	
	03.02.0061	Middle side panel/right/H7		1	
3	03.02.0186	Rear side panel left/H7		1	
	03.02.0187	Rear side panel right/H7		1	



4	03.02.0319	Headlamp assembly/H7/YP-00-22	12V/12W/LED bulb/full black lampshade	1	
5	03.02.0124	Front fenders/H7	red	1	
6	03.02.0059	Rear tail panel/rear fender/H7		1	
7	03.02.0012	Rear inner plate/H7	Black PP plastic parts	1	
8	03.02.0320	Headlamp bracket (left and right) / H7	Spray black/Fitted with YP-00-22 headlights	2	
9	03.02.0058	Number plate/H7	red	1	

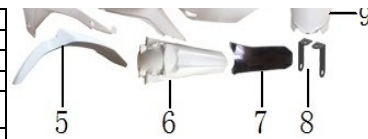

FUEL TANK & SEAT					
NO	PART NUMBER	NAME	DESCRIPTION	QTY	
1	03.05.0085	Fuel cap/K5, H7	Include mat and fit	1	
2	03.02.0112	Fuel tank/H7-01	KKA093	1	
3	03.01.0148	Fuel tank front fixing/A7-01	Black plastic	2	
4	05.01.07.06012D	Allen countersunk	M6*25/stainless steel	2	
5	06.54.0004	Gasoline filter - type C		1	
6	03.05.0039	Oil switch/K5-01	KKA093	1	
7	03.02.0108	Oil switch bracket/H7-01	Spray black	1	
8	03.02.0109	Fuel tank front fixing bracket/H7-01	Black plastic	1	
9	03.02.0110	Rubber ring/H7-01 fixed in front of the tank	Black rubber	1	
10	03.02.0289	Seat cushion assembly/H7	Red background, 6 black and yellow horizontal bars, EGL wing logo	1	



RADIATOR SYSTEM					
NO	PART NUMBER	NAME	DESCRIPTION	QTY	
1	03.02.0009	Tank guard/left/H7	White PP plastic parts	1	
2	03.02.0010	Tank guard/right/H7		1	
3	03.02.0094	Water tank/H7/left/NC250	With fan, with temperature switch/NC250	1	
4	03.02.0093	Water tank/H7/right	With auxiliary water tank/250cc/aluminum alloy natural color	1	
5	03.01.0123	Water tank shroud bracket rubber pad/T3 headlight rubber ring/A7-04	10*21MM	1	
6	03.06.0077	Outlet pipe /K7		1	
7	03.07.0070	Connection pipe/X7 (engine/NC250/ZS included)	(Engine/NC250/ZS included), black polyurethane	1	
8	03.07.0071	Inlet pipe/X7 (engine/NC250/ZS included)	(Engine/NC250/ZS included), black polyurethane	1	
9	03.01.0065	WATER TANK CLAMP 16*25*8MM	16*25*8MM	1	

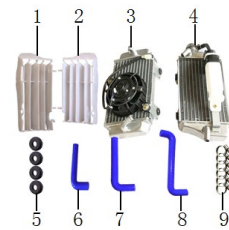

GRAPHIC					
NO	PART NUMBER	NAME	DESCRIPTION	QTY	
1	03.02.0298	Decal/A17	RED/A17/EGL	1	
2	06.57.0010	Diamond chest pad (large) / packing accessory	With 28 diameters	1	
3	06.57.0020	Chest guard plastic buckle (large) / packaging accessory		1	

